



4400 Single Hung Window w/ Nailing Fin "NON-IMPACT"

GENERAL NOTES

1. This product anchoring drawing has been evaluated and is in compliance with the 5th Edition (2014) Florida Building Code (FBC) excluding the "High Velocity Hurricane Zone" (HVHZ). See the Certification Agency Certificate for sizes, specifications & ratings.
2. Product anchors shall be as listed and spaced as shown on details. Anchor embedment to base material shall be beyond wall dressing or stucco.
3. When used in areas requiring wind borne debris protection, this product is required to be protected with an impact resistant covering that complies with Section 1609.1.2 of the FBC.
4. Site conditions that deviate from the details of this drawing require further engineering analysis by a licensed engineer or registered architect.

TABLE OF CONTENTS	
SHEET#	DESCRIPTION
1	Typical elevations, design pressures & general notes
2	Vertical & horizontal cross sections
3	Vertical & horizontal cross sections
4	Buck & frame anchoring
5	Bill of materials, components and glazing detail

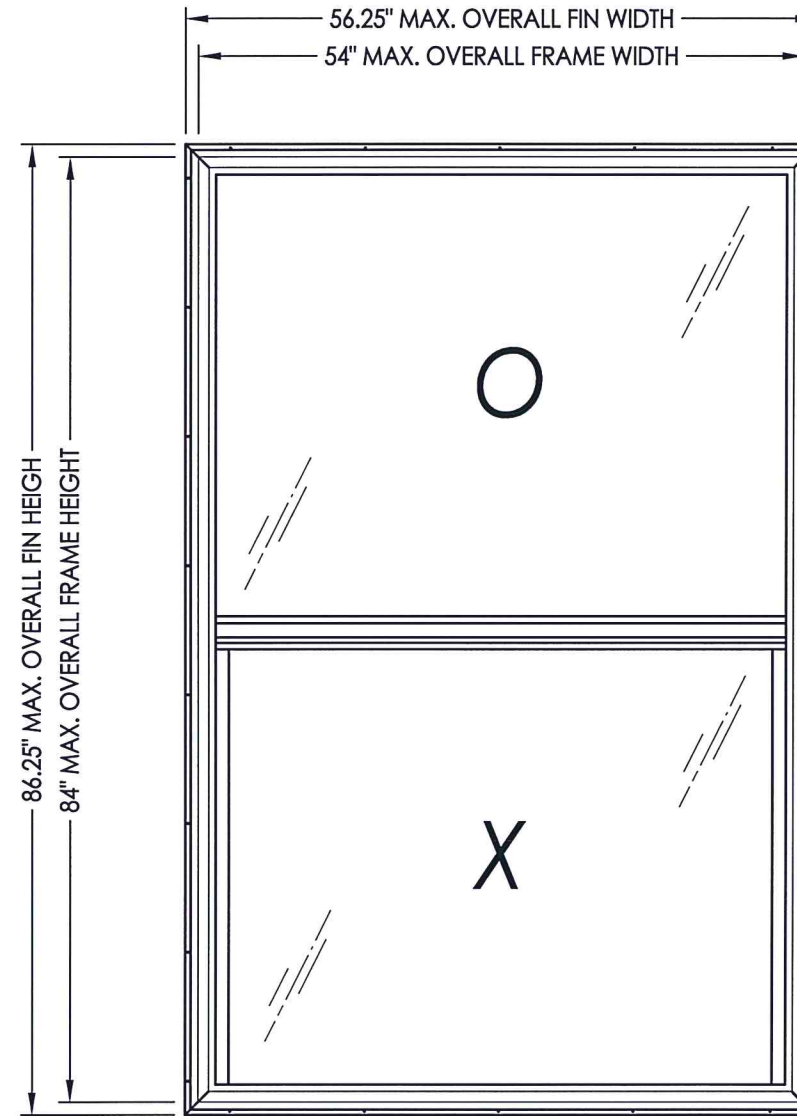

MAX. O.A. FIN DIMENSION	MAX. O.A. FRAME DIMENSION	MAX. SASH D.L.O. DIMENSION	MAX. FIXED D.L.O. DIMENSION	GLASS TYPE	DESIGN PRESSURE (PSF)	
					POSITIVE	NEGATIVE
56.25" x 86.25"	54" X 84"	48.25" X 37.5"	50.75" X 39.5"	G1	+35.0	-35.0
56.25" x 78.25"	54" X 76"	48.25" X 33.5"	50.75" X 35.5"	G1	+45.0*	-45.0
39.25" x 64.25"	37" X 62"	31.25" X 26.5"	33.75" X 28.5"	G1	+75.0*	-80.0

*Requires sill riser

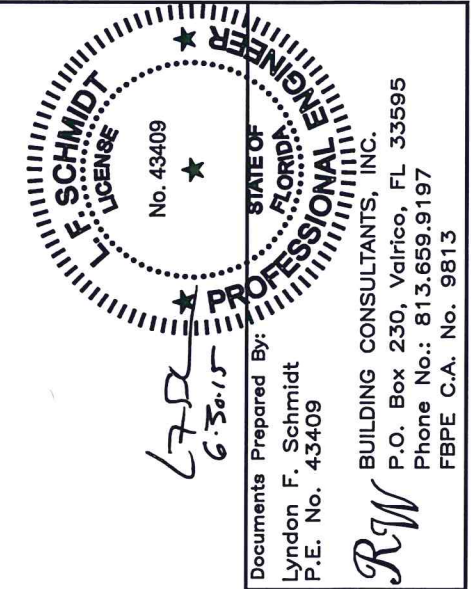

PRODUCT: SINGLE HUNG WINDOW	
PART OR ASSEMBLY: TYPICAL ELEVATION, DESIGN PRESSURES & GENERAL NOTES	
NO.	DATE
BY	REVISIONS
DATE: 6/26/15	
SCALE: N.T.S.	
DWG. BY: JK	
CHK. BY: LFS	
DRAWING NO.: FL-16854.7	
SHEET 1 OF 5	

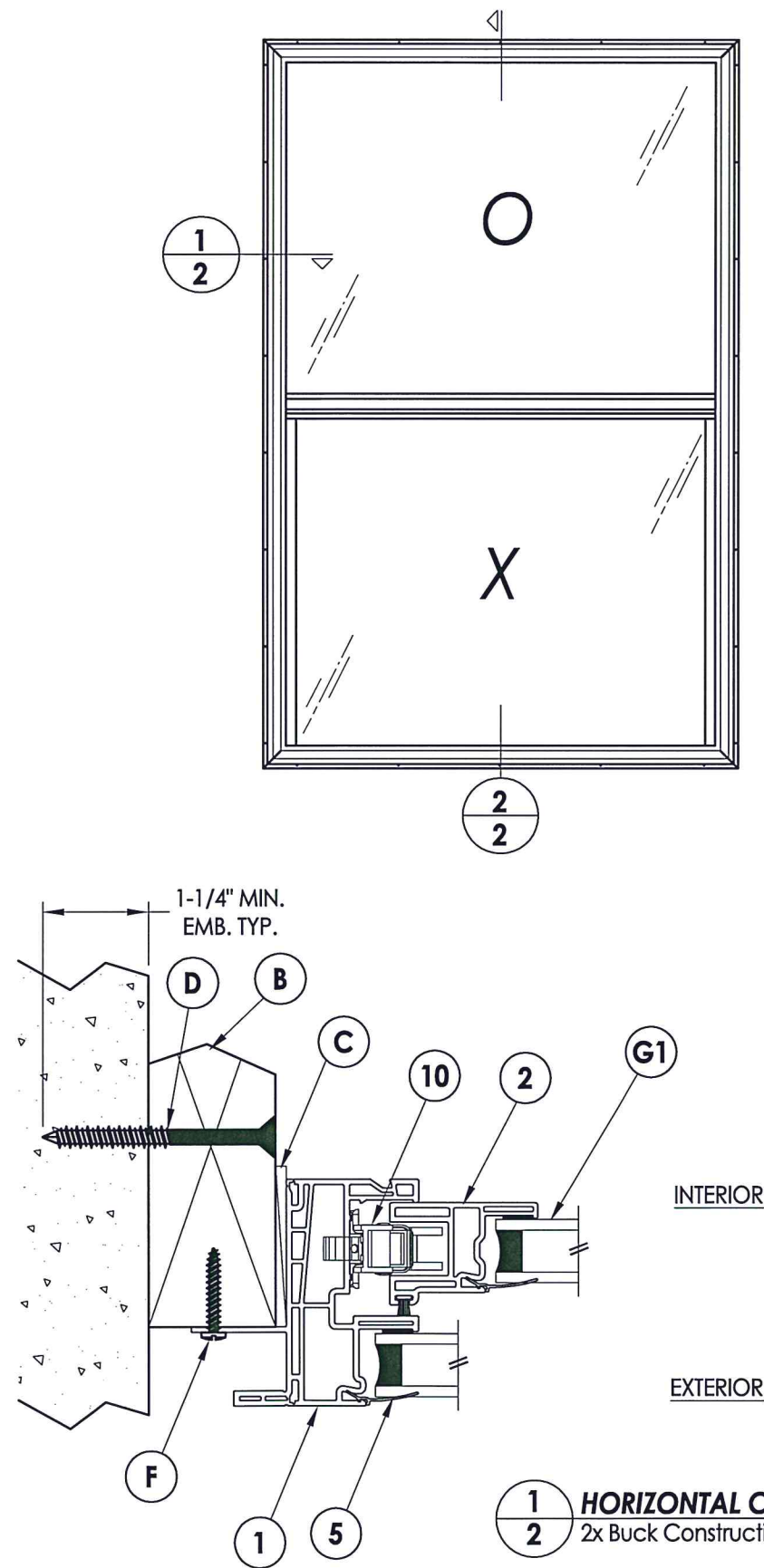

1 HORIZONTAL CROSS SECTION
2 2x Buck Construction

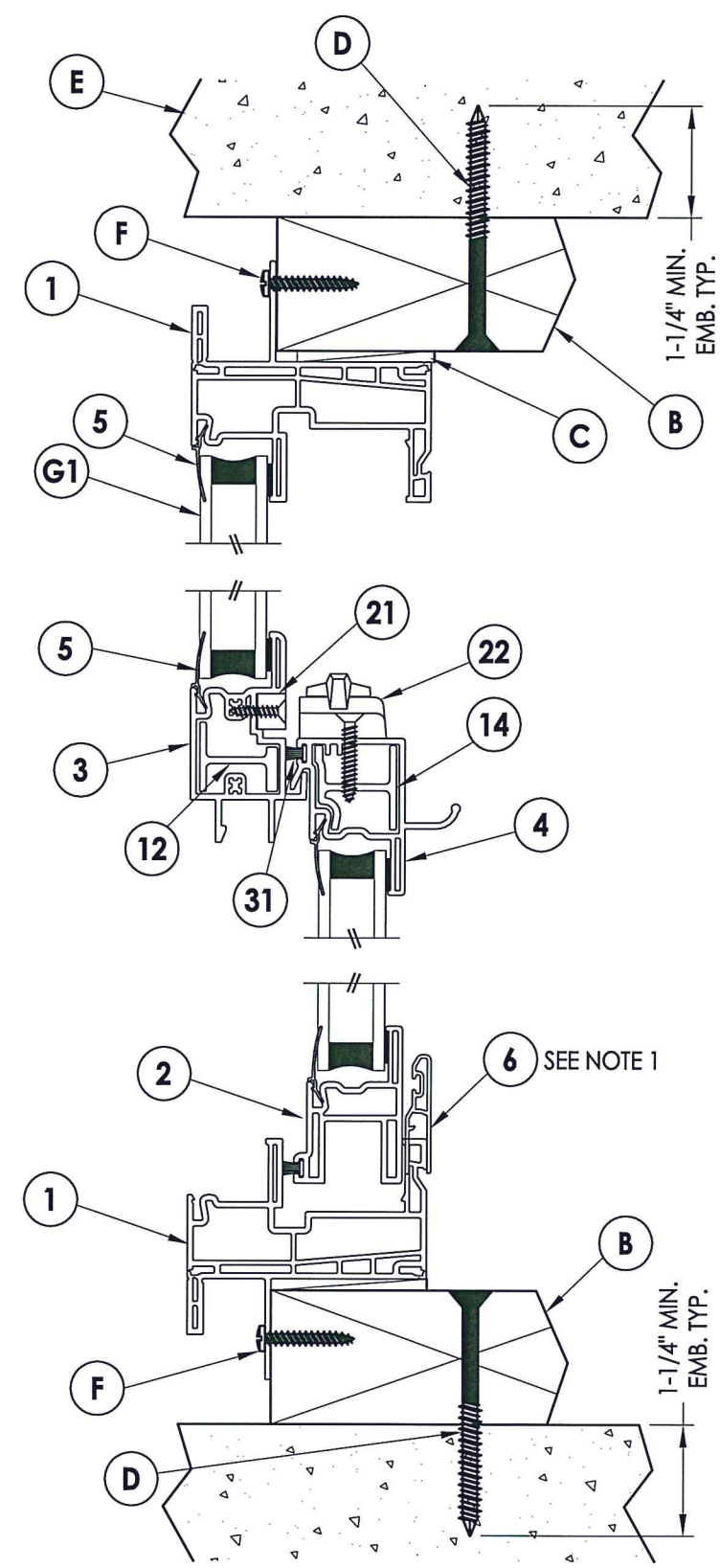

2 VERTICAL CROSS SECTION
2 2x Buck Construction

NOTES:
 1. Sill riser required when positive design pressure > 35 psf.

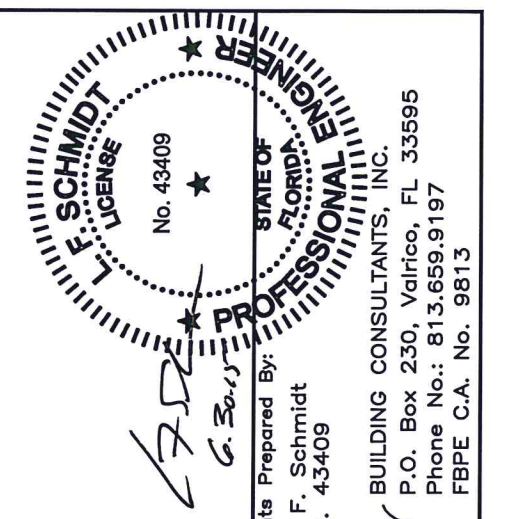

Documents Prepared By:
 Lyndon F. Schmidt
 P.E. No. 43409

RW
 BUILDING CONSULTANTS, INC.
 P.O. Box 230, Valrico, FL 33595
 Phone No.: 813.659.9197
 FBPE C.A. No. 9813

PRODUCT: SINGLE HUNG WINDOW
 PART OR ASSEMBLY: VERTICAL & HORIZONTAL CROSS SECTIONS

NO.	DATE	BY	REVISIONS

DATE: 6/26/15
 SCALE: N.T.S.
 DWG. BY: JK
 CHK. BY: LFS
 DRAWING NO.: FL-16854.7
 SHEET 2 OF 5

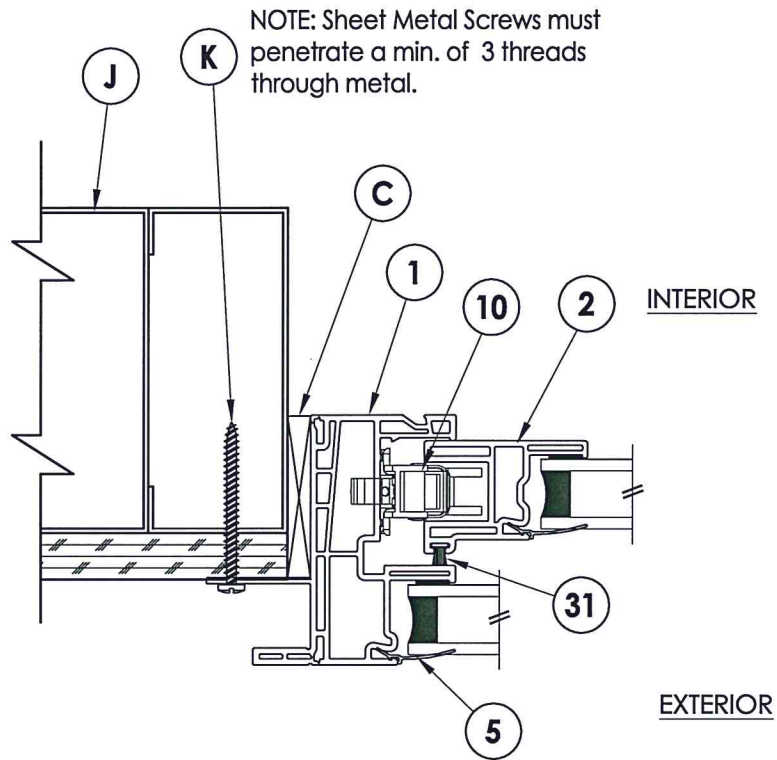
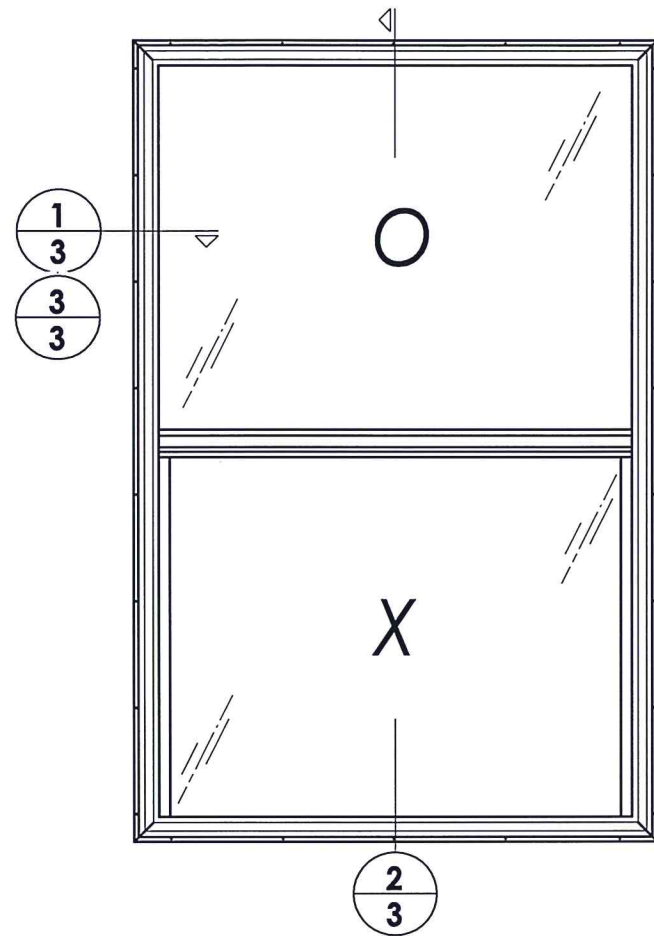

3 HORIZONTAL CROSS SECTION
3 Shown w/ Steel Stud Framing Option

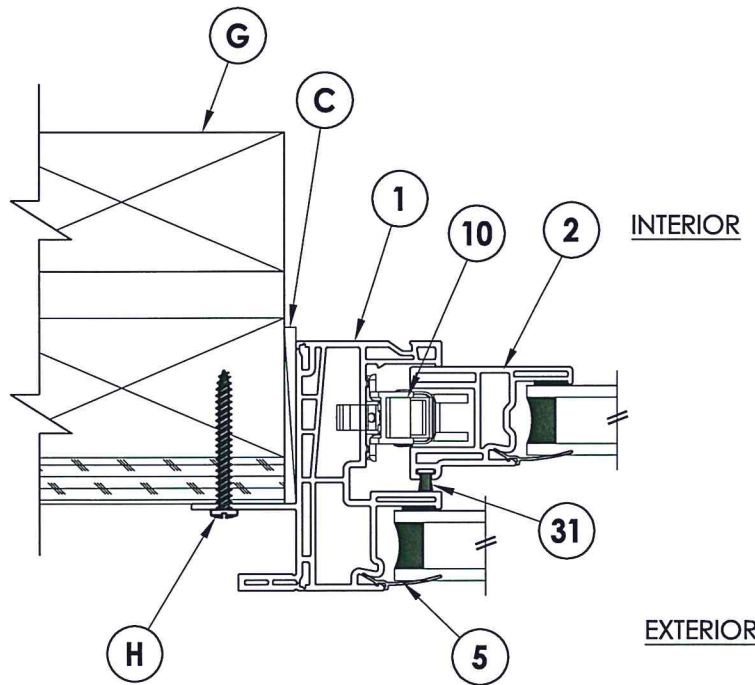

1 HORIZONTAL CROSS SECTION
3 Stud Construction

NOTES:
1. Sill riser required when positive design pressure > 35 psf.

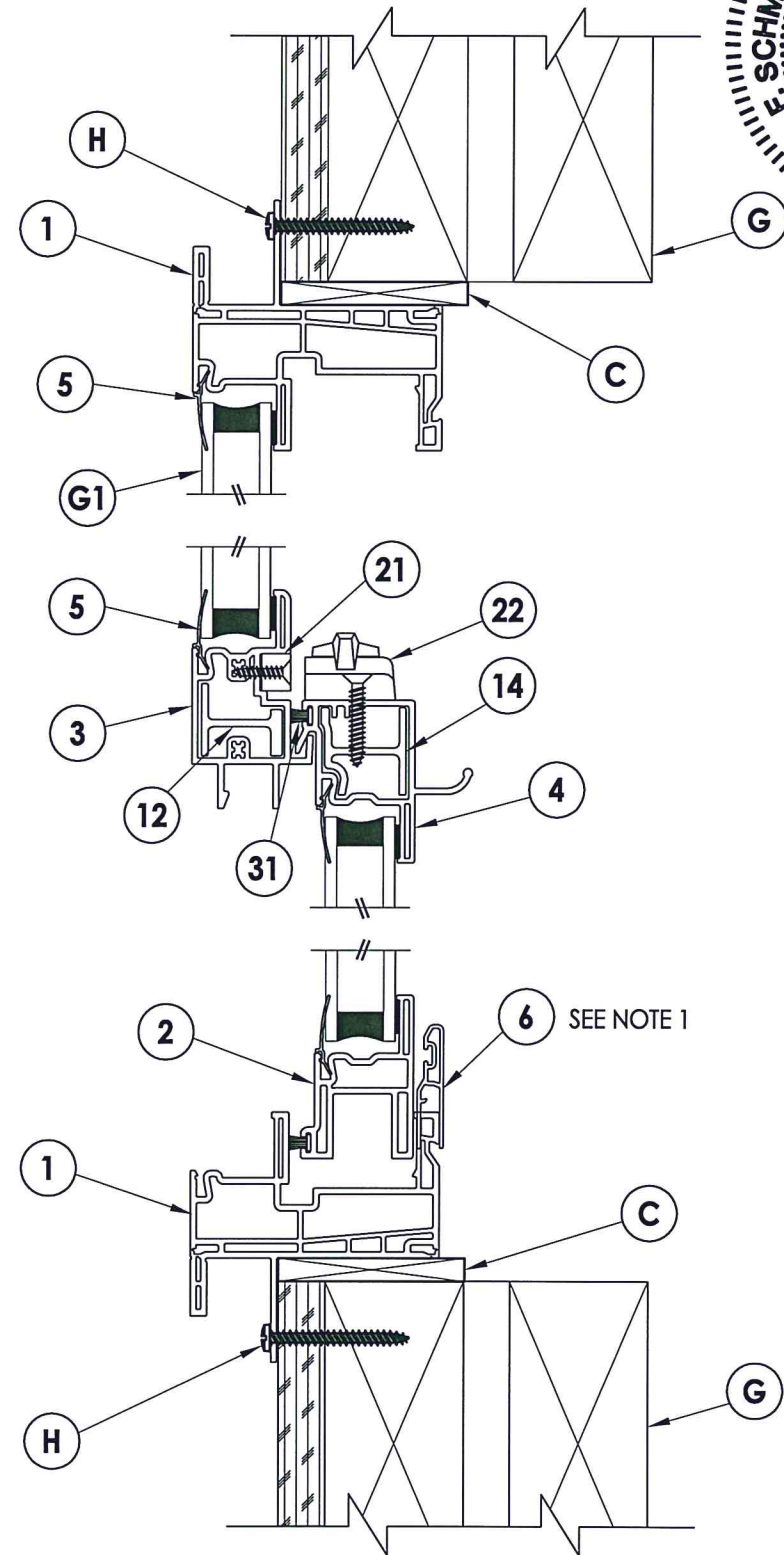

2 VERTICAL CROSS SECTION
3 Stud Construction

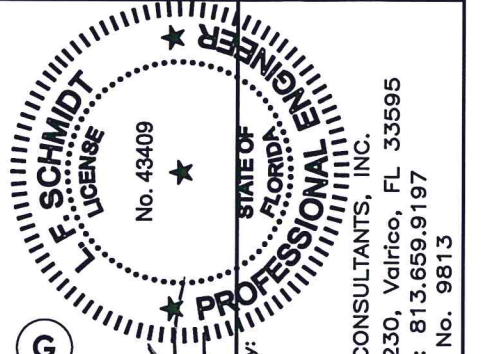

Documents Prepared By:
Lyndon F. Schmidt
P.E. No. 43409

RW BUILDING CONSULTANTS, INC.
P.O. Box 230, Valrico, FL 33595
Phone No.: 813.659.9197
FBPE C.A. No. 9813

PRODUCT:	SINGLE HUNG WINDOW
PART OR ASSEMBLY:	VERTICAL & HORIZONTAL CROSS SECTIONS
NO.	DATE
BY	REVISIONS
DATE: 6/26/15	
SCALE: N.T.S.	
DWG. BY: JK	
CHK. BY: LFS	
DRAWING NO.: FL-16854.7	
SHEET 3 OF 5	

Z:\Clients\Doers PERMANENT\Florida Product Approvals\FL-16854 Windows - Single Hung\C - Drawings\FL-16854 (2014)\FL-16854.7-14.dwg, 1-4

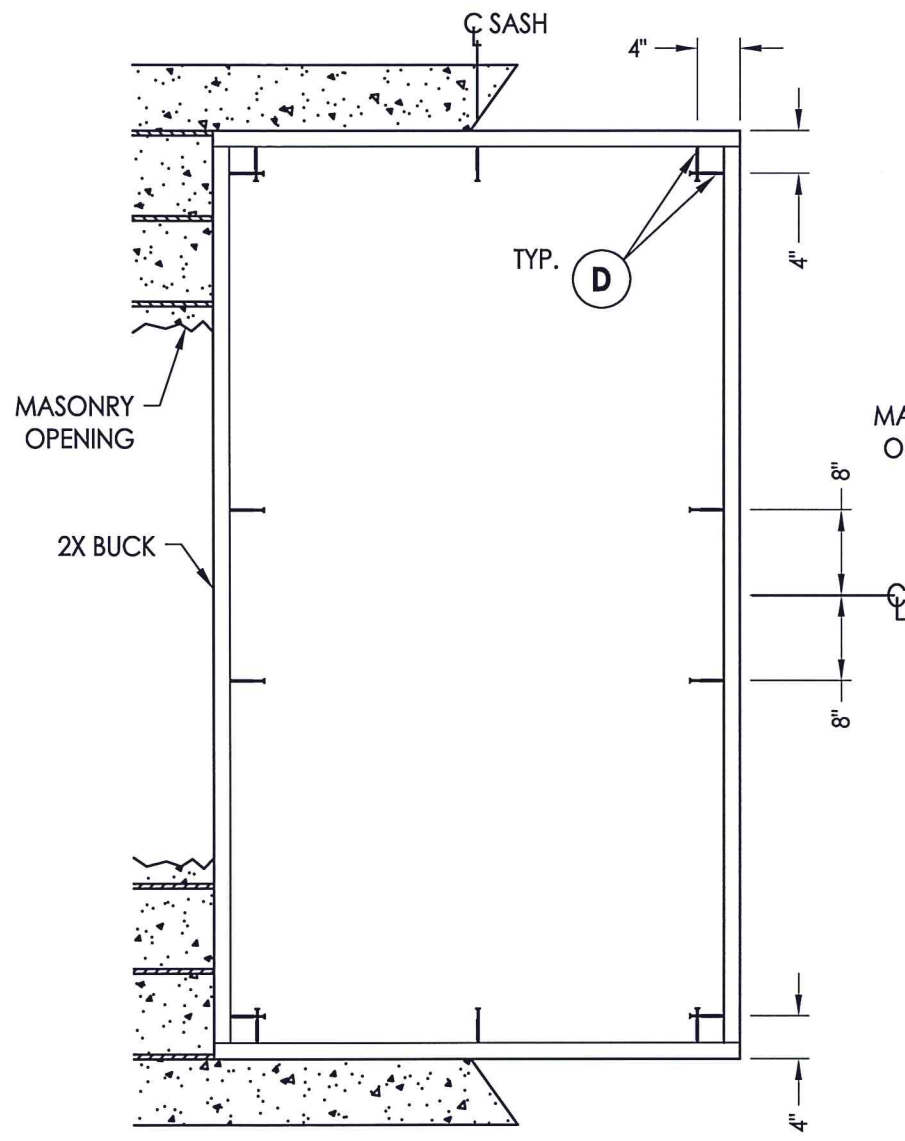

BUCK ANCHORING

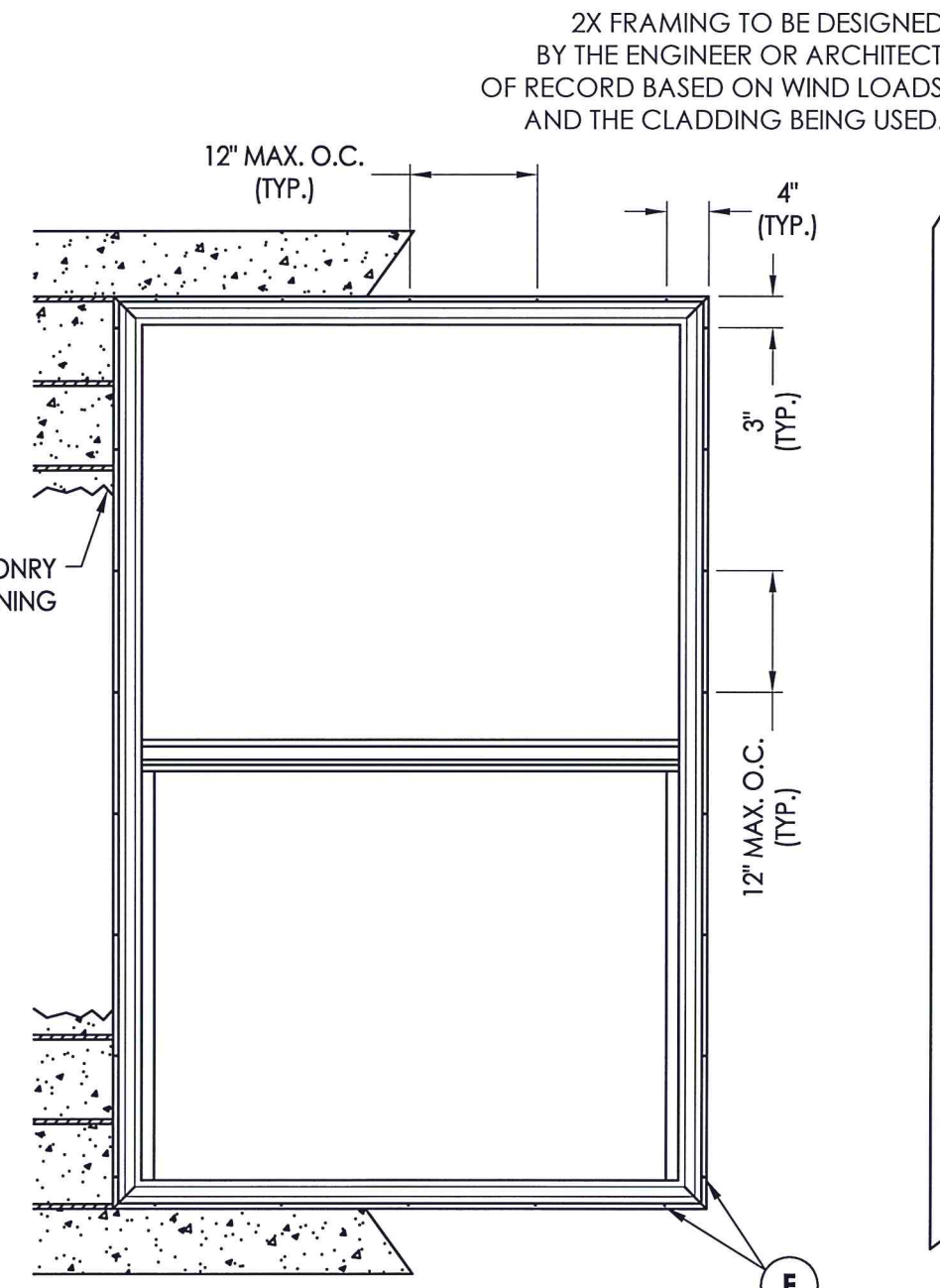

**FRAME ANCHORING
MASONRY CONSTRUCTION**

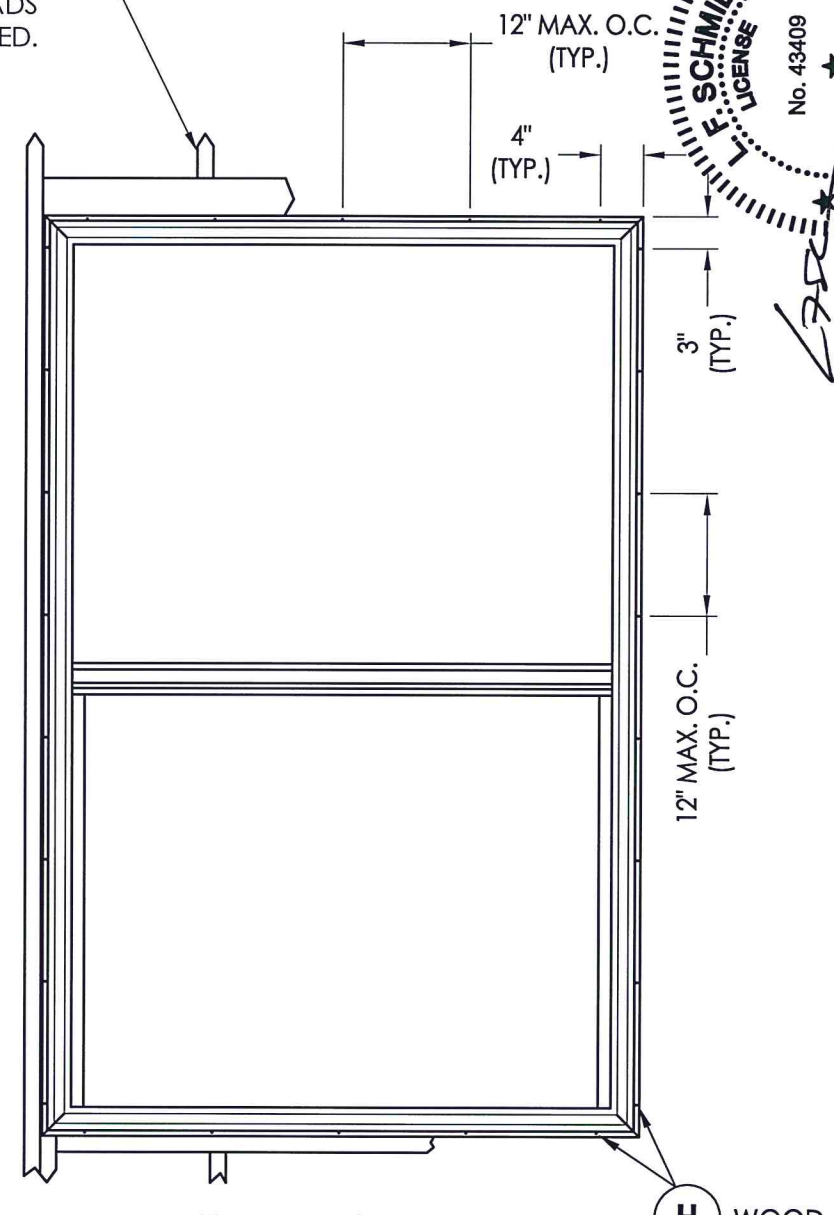

**FRAME ANCHORING
STUD CONSTRUCTION**

H WOOD
K STEEL
TYP.

2X FRAMING TO BE DESIGNED BY THE ENGINEER OR ARCHITECT OF RECORD BASED ON WIND LOADS AND THE CLADDING BEING USED.

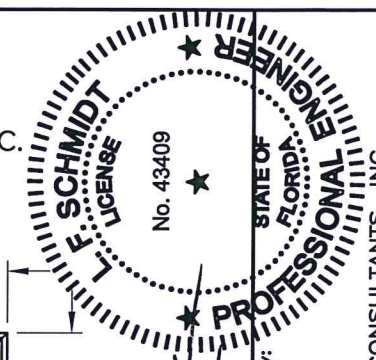

Documents Prepared By:
Lyndon F. Schmidt
P.E. No. 43409

RW BUILDING CONSULTANTS, INC.
P.O. Box 230, Valrico, FL 33595
Phone No.: 813.659.9197
FBPE C.A. No. 9813

PRODUCT: SINGLE HUNG WINDOW
PART OR ASSEMBLY: BUCK & FRAME ANCHORING

NO.	DATE	BY	REVISIONS

DATE: 6/26/15
SCALE: N.T.S.
DWG. BY: JK
CHK. BY: LFS
DRAWING NO.: FL-16854.7
SHEET 4 OF 5

CONCRETE ANCHOR NOTES:

- Concrete anchor locations at the corners may be adjusted to maintain the min. edge distance to mortar joints.
- Concrete anchor locations noted as "MAX. ON CENTER" must be adjusted to maintain the min. edge distance to mortar joints, additional concrete anchors may be required to ensure the "MAX. ON CENTER" dimension are not exceeded.
- Concrete anchor table:

ANCHOR TYPE	ANCHOR SIZE	MIN. EMBEDMENT	MIN. CLEARANCE TO MASONRY EDGE	MIN. CLEARANCE TO ADJACENT ANCHOR
ITW TAPCON®	1/4"	1-1/4"	2"	4"
ELCO ULTRACON®	1/4"	1-1/4"	1"	4"

WOOD SCREW INSTALLATION NOTES:

- Maintain a minimum 5/8" edge distance, 1" end distance, & 1" o.c. spacing of wood screws to prevent the splitting of wood.

BILL OF MATERIALS		
ITEM #	DESCRIPTION	MATERIAL
B	2X BUCK (SG >= 0.42)	WOOD
C	1/4" MAX. SHIM SPACE	-
D	1/4" X 2-3/4" PFH ELCO OR ITW CONCRETE SCREW	STEEL
E	MASONRY - 3,000 PSI MIN. CONCRETE CONFORMING TO ACI 301 OR HOLLOW BLOCK CONFORMING TO ASTM C90	CONCRETE
F	#8 X 1" PFH WS (7/8" MIN. EMBEDMENT)	STEEL
G	2X STUD (SG=> 0.42)	WOOD
H	#8 X 1-1/2" PFH WS (7/8" MIN. EMBEDMENT)	STEEL
J	STEEL STUD Min. Thk .033" (ASTM A653 GRADE 33 Fy=33 ksi min., Fu=45 ksi min.)	STEEL
K	#10 PPH SELF-DRILLING SMS	STEEL
1	HEAD - SILL - JAMB*	PVC
2	STILE / BOTTOM RAL*	PVC
3	MEETING RAIL*	PVC
4	LOCK RAIL*	PVC
5	GLAZING BEAD*	PVC
6	SILL ADAPTOR*	PVC
10	WINDOW BALANCE	-
12	REINFORCEMENT (MEETING RAIL)	6063-T6 ALUM.
14	REINFORCEMENT (LOCK RAIL)	6063-T6 ALUM.
21	KEEPER	-
22	LOCK ASSEMBLY	-
31	CENTER FIN PILE - .270 X .220	-

* THE APPROVED WHITE RIGID PVC EXTERIOR EXTRUSIONS FOR WINDOWS ARE TO BE PRODUCED BY EXTRUDERS LICENSEES IN "AAMA CERTIFICATION PROGRAMS FOR RIGID PVC EXTRUSIONS".

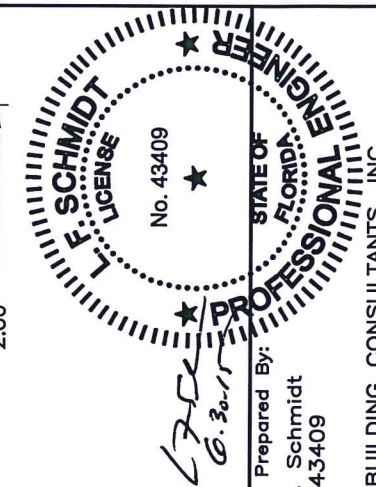
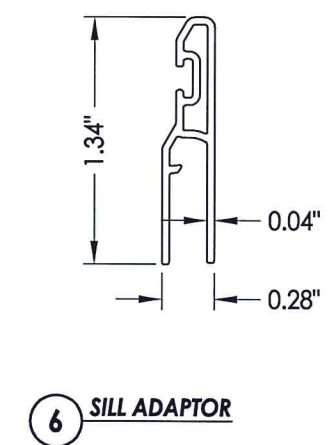
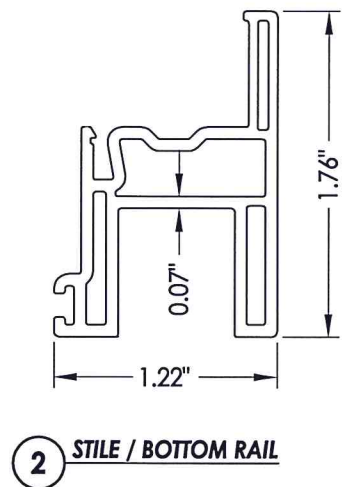
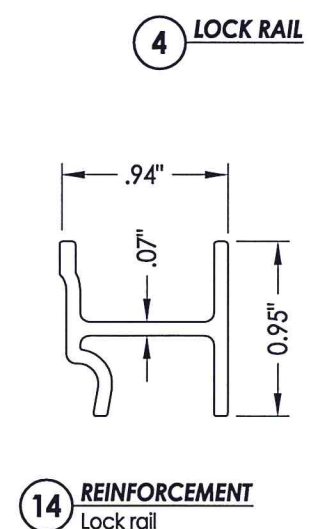
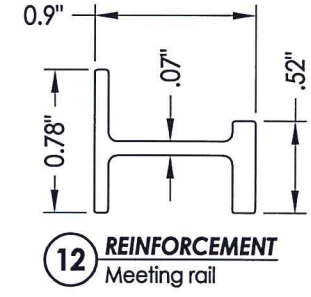
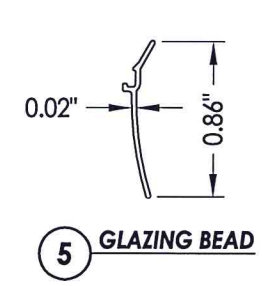
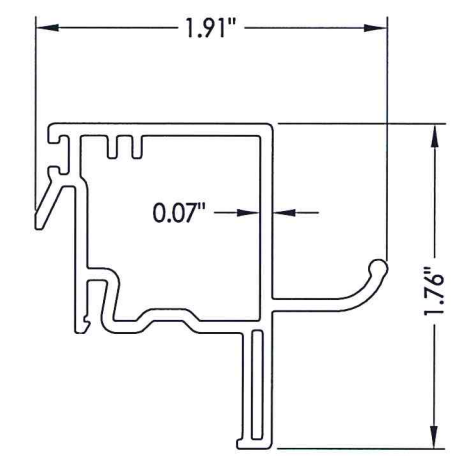
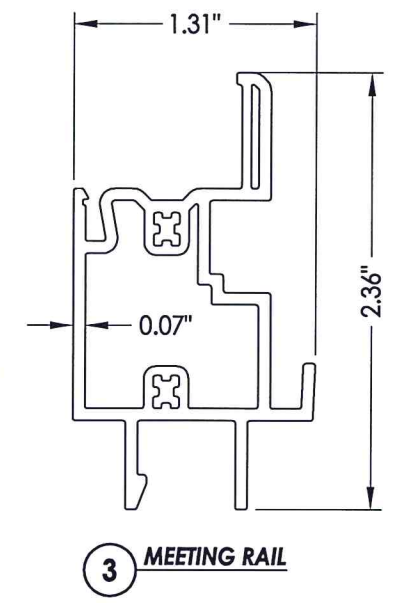
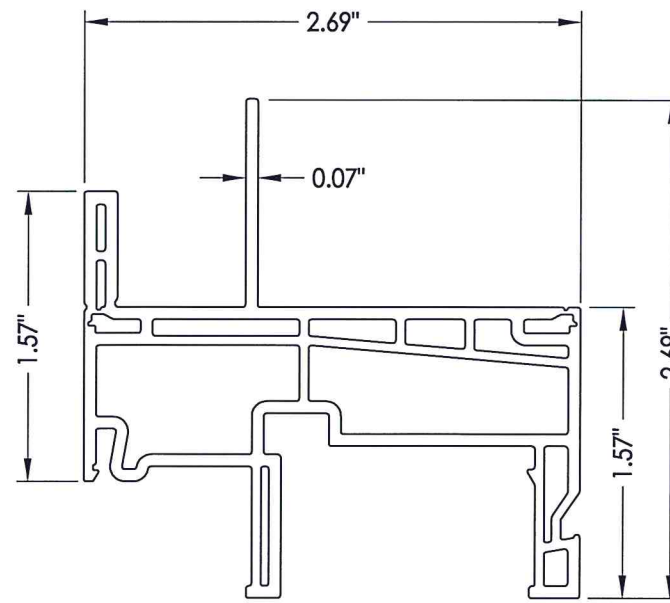
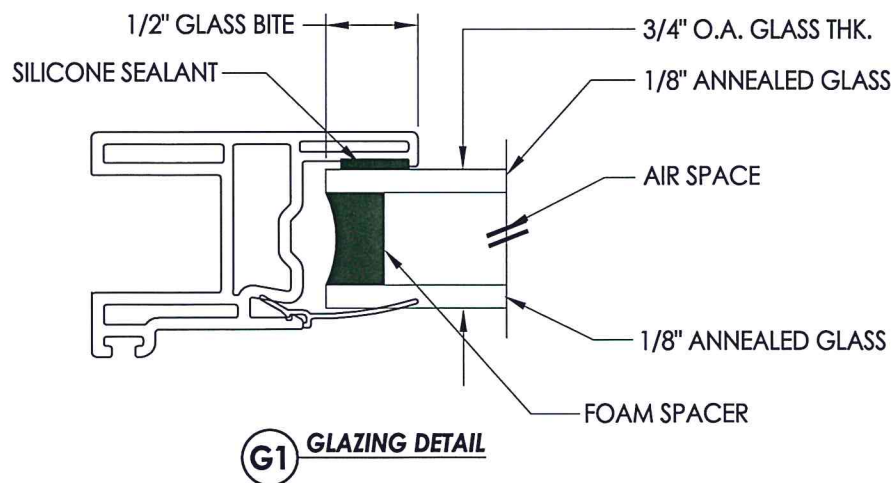

Documents Prepared By:
 Lyndon F. Schmidt
 P.E. No. 43409

RW BUILDING CONSULTANTS, INC.
 P.O. Box 230, Vairico, FL 33595
 Phone No.: 813.659.9197
 FBPE C.A. No. 9813

PRODUCT: SINGLE HUNG WINDOW
 PART OR ASSEMBLY: BILL OF MATERIALS, COMPONENTS AND GLAZING DETAIL

NO.	DATE	BY	REVISIONS

DATE: 6/26/15
 SCALE: N.T.S.
 DWG. BY: JK
 CHK. BY: LFS
 DRAWING NO.: FL-16854.7
 SHEET 5 OF 5